



TIMBERLOOK

SLIM-SASH PVC-u BI-FOLD DOORS

Most PVCu Bi-Folding Doors are made from bulky door profile & include unsightly face-fixed hinges.

Timberlook Slimline Bi-Fold Doors are different.

We combine high-strength PVCu & Aluminium profiles to achieve the sight lines of aluminium bi-folds with the cost-effectiveness of PVCu.



Timberlook Slimline Bi-Folding Doors **are available in a wide range of woodgrain foil colours that look just as effective as traditional solid timber-framed windows**



Standard White PVCu profile plus Light Oak & Rosewood Woodgrain also available

Main Timberlook Features

- Replicate timber sections with an ovolo profile.
- Have high-security hardened steel hook locks that prevent the hinge being forced from the door.
- Have high performance double seals to every door and thermally efficient double glazing with a u value of 1.6.
- Are available with our exclusive concealed night ventilation.
- Include encapsulated stainless steel rollers built into the top & bottom tracks to prevent the doors from being lifted out the track.
- Sightline between glass is 130mm, which is the same as the Smarts 1000 aluminium bi fold.
- Compliment our range of Timberlook casement windows which can be used to design matching conservatories.

Timberlook Bi-Folds are available in the following colours on both sides: Rosewood, Light Oak, Irish Oak, Black, Grey, Polar White, Chartwell Green, Fir Green and Cream Foils.

All the above are available with flat white on the inside.

MATCHING PROFILE & COLOURS ARE AVAILABLE FOR CONSERVATORIES & WINDOWS

Colours are only as close as the printing process allows - The manufacturer reserves the right to change product & specification as technical developments dictate without notice

ALUMINIUM HEADER AND THRESHER RAILS

GUIDE
ROLLERS

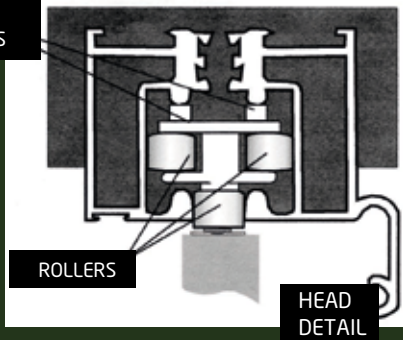

The Head & Thresher are aluminium and do not have a PVC-u frame and as such are more robust

The Aluminium Head & Thresher encapsulate the running gear so that the door cannot be lifted from the track.



Maximum sash width is 750mm.

Maximum width of Bi-Fold Doors as follows:

2 Door	3 Door	4 Door	5 Door	6 Door
Not Available	2491 mm	3188 mm	4012 mm	4712 mm

- The Timberlook Bi-Fold aluminium thresher is **51mm high**.
- The Threshold can be fitted flush to the inside and outside floor and is also available with an external clip-on aluminium cill that does not increase the threshold height of 51mm.
- The rollers are concealed and are resistant to attack from potential intruders.
- Hardened steel hook locks, dead bolts and top/bottom shootbolts are specified for high security and flat handles minimize stacking space when opened.
- The wheels, which are stainless steel, operate quietly and smoothly and have sealed bearings for maintenance free use.
- There are 4 expansion seals between each door.

OPTION 1

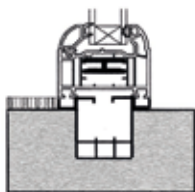

It is possible to recess the track 45mm into the floor.

OPTION 2

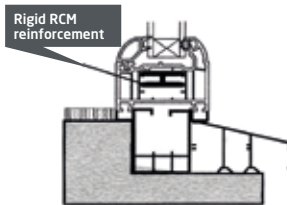

By lowering the external brickwork - the track can be installed flush with the internal floor.

OPTION 3

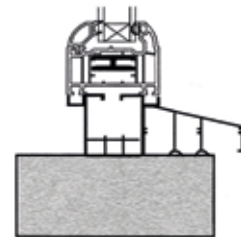

Fitted in the conventional way the upstand is only **51mm** while conventional PVC-u Bi-Folding doors have an upstand between **100mm and 140mm**.

THRESHER AND SIGHTLINE DETAILS

Timberlook bi-folds feature our exclusive concealed night vent hood extension.

AW42 - Night Vent Head Extension 42mm

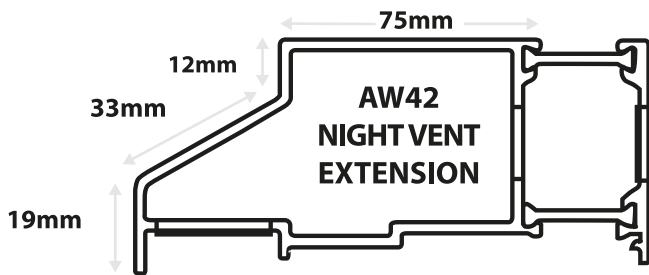

**Encapsulated Steel Rollers
& Concealed Hinge Fixing.**



New Slave Handles

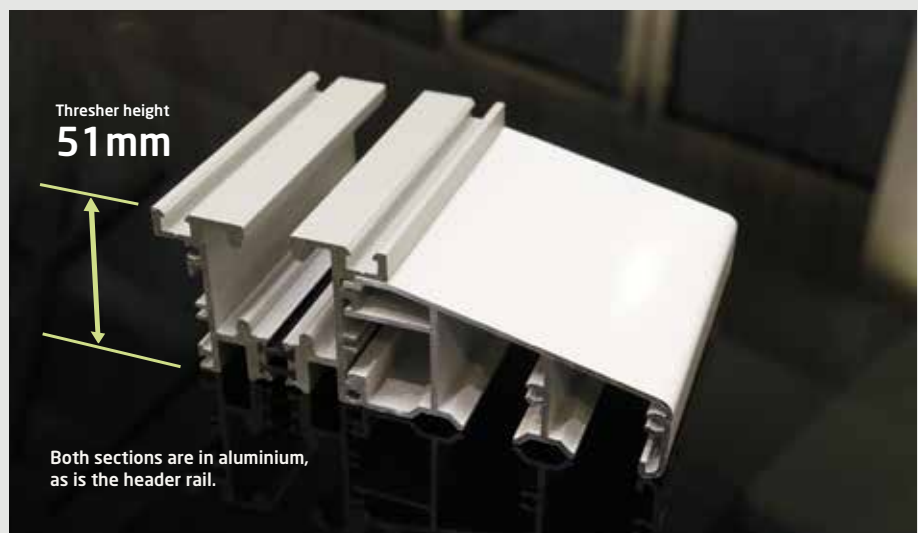

Cill section clips in to the threshold keeping the overall thresher height at 51mm